





The Langdale

Relaxation comes naturally here. Take off well stomped boots and enjoy a peaceful cuppa in the light of the dinette feature window. New nature inspired prints and textures encourage the outdoors in. Every element of ease has been considered for a seriously savourable switch-off.



Feel well-rested while surrounded by nature

Please note: Some items featured in this photography are scene-setting props or optional extras, not included in your purchase. Please speak to your park or dealership or refer to the 'all this included' section for this holiday home.





Highlights:

- Updated colour scheme for 2025
- Luxury wood burner style feature fireplace
- Free-standing domestic style seats
- Modern spacious kitchen
- Natural contemporary feature slatted wall panelling to lounge



The Langdale

The only decision you need to make here is two bedrooms or three. Savour the downtime and drink it all in.

For external CanExel™ Cladding option please visit www.abiuk.co.uk



For more information and to take a virtual tour, visit www.abiuk.co.uk

All this included

- ✓ Matt finish Champagne aluminium cladding
- ✓ Pre-galvanised twin axle chassis
- ✓ Full front sliding door
- ✓ White 'Low E' PVCu Thermaglass double glazing
- ✓ Fully condensing boiler gas central heating
- ✓ Luxury wood burner style feature fire
- ✓ Carpet underlay throughout
- ✓ Free-standing dining table and chairs
- ✓ Satellite co-ax
- ✓ USB socket in lounge
- ✓ Scatter cushions in lounge
- ✓ Voiles throughout
- ✓ Soft-close hinges on doors and drawers in kitchen
- ✓ Integrated oven and separate 5 burner hob
- ✓ 40mm worktops
- ✓ Integrated fridge freezer
- ✓ Externally vented powered cooker hood
- ✓ Lift-up bed in master bedroom
- ✓ TV point in all bedrooms
- ✓ USB sockets in all bedrooms
- ✓ King size bed in master bedroom (2 bedroom model only)
- ✓ Composite kitchen sink

- ✓ Plain duvet covers and pillowcases
- ✓ Bed runners and scatter cushions on all beds
- ✓ En suite shower (2 bedroom model only)
- ✓ En suite toilet
- ✓ Bathroom extractor fans
- ✓ Shaver socket
- ✓ Additional sockets next to TV point in lounge
- ✓ Hooks in all bathrooms
- ✓ Entrance hall and cloakroom
- ✓ Stylish pictures throughout
- ✓ Full front sliding door
- ✓ Crib 5 mattresses to all bedrooms

Add any of these

- Residential specification BS3632
- Deluxe Bluetooth sound system
- 'Exclusive' pocket sprung mattresses
- Space saver bed for twin room
- Integrated washing machine
- Integrated dishwasher
- Integrated microwave oven
- Fully galvanised chassis
- CanExel™ exterior cladding
- Vinyl flooring in lounge in lieu of carpet

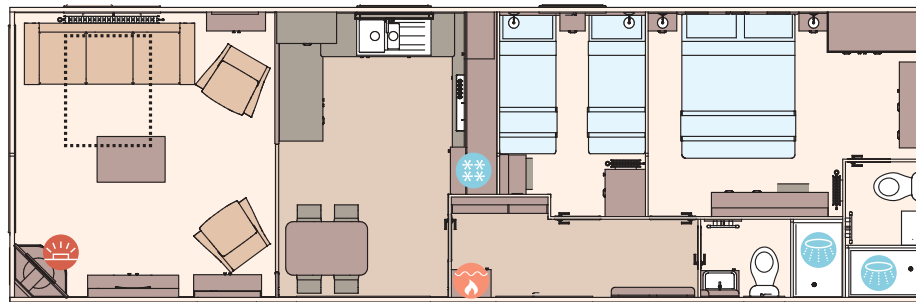

The Langdale 40ft x 13ft x 2 bedroom

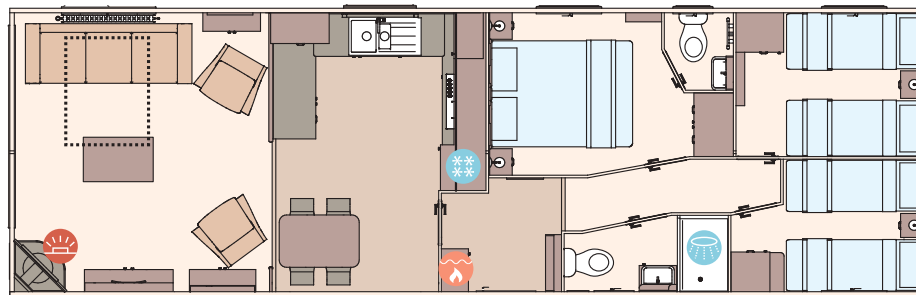

The Langdale 41ft x 13ft x 3 bedroom

KEY:

- Fire
- Water heater
- Shower
- Fridge/Freezer
- Front pull out bed

OPTIONAL
Residential
specification
BS3632
See Page 86