





Shows optional Air Conditioning unit

The Ingleton

Surround yourself within a contemporary aesthetic, thoughtfully crafted down to the finest details. Plush textures, sleek features and modern style notes give this space a chic hotel feel to savour. Select something sumptuous from the wine rack and indulge in the spaciousness of the L-shaped sofa. The wind-down is too easy here.



Step in and chill out

Please note: Some items featured in this photography are scene-setting props or optional extras, not included in your purchase. Please speak to your park or dealership or refer to the 'all this included' section for this holiday home.





Shows optional Air Conditioning unit

Highlights:

- New layout and colour scheme for 2025
- New feature fireplace in lounge
- Open-plan family holiday home with breakfast bar
- Option to upgrade to BS3632 residential specification



The Ingleton

If this holiday home's chic style is for you, there's only one decision left. Which of the two fantastic layouts will you choose?



For more information and to take a virtual tour, visit www.abiuk.co.uk

All this included

- ✓ Matt finish Chateaux grey aluminium cladding
- ✓ Pre-galvanised twin axle chassis
- ✓ Full front sliding door
- ✓ White 'Low E' PVCu Thermaglass double glazing
- ✓ Fully condensing boiler gas central heating
- ✓ Free-standing dining table and 4 chairs
- ✓ Breakfast bar
- ✓ Breakfast style stools
- ✓ Satellite co-ax
- ✓ USB socket in lounge
- ✓ Scatter cushions in lounge
- ✓ Voiles throughout
- ✓ Soft-close hinges on doors and drawers in kitchen
- ✓ 40mm worktops
- ✓ Integrated fridge freezer
- ✓ Externally vented powered cooker hood
- ✓ Lift-up bed in master bedroom
- ✓ TV point in all bedrooms
- ✓ USB sockets in all bedrooms
- ✓ King size bed in master bedroom (2 bedroom model only)
- ✓ Separate en suite toilet and shower in all models

- ✓ Bathroom extractor fans
- ✓ Shaver socket
- ✓ Additional sockets next to TV point in lounge
- ✓ Hooks in all bathrooms
- ✓ Composite kitchen sink
- ✓ Full front sliding door
- ✓ Crib 5 mattresses to all bedrooms
- ✓ Contemporary radiator in lounge

Add any of these

- Residential specification BS3632
- Deluxe Bluetooth sound system
- 'Exclusive' pocket sprung mattresses
- Space saver bed for twin room
- Integrated washing machine
- Integrated dishwasher
- Integrated microwave oven
- Fully galvanised chassis
- CanExel™ exterior cladding
- Graphite grey windows and doors with optional matching internal linings

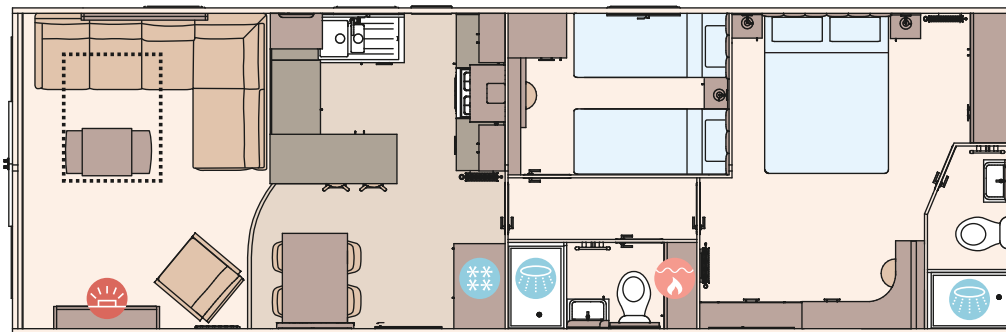

The Ingleton 40ft x 13ft x 2 bedroom

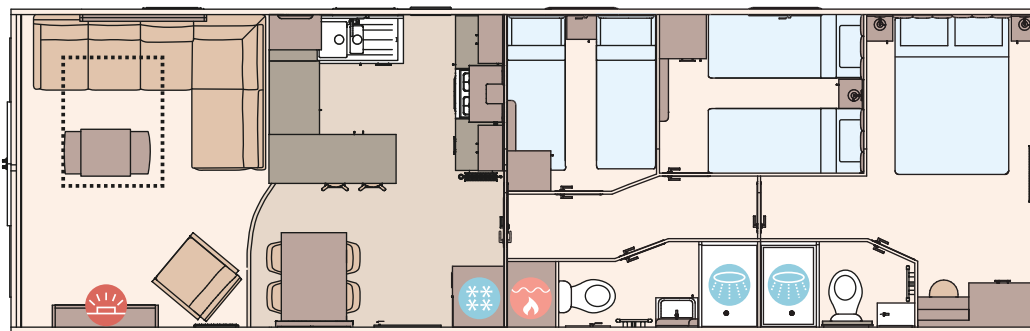

The Ingleton 41ft x 13ft x 3 bedroom

KEY:

- Fire
- Water heater
- Shower
- Fridge/Freezer
- Front pull out bed

OPTIONAL
Residential
specification
BS3632
See Page 86

OPTIONAL
WINTER
PACKS
See Page 86